

# Battery Operated Window Candle - VT-1524 Series

(For Indoor Use Only)

## INSTRUCTIONS:

1. Unscrew the bulb.
2. Insert 4x AA alkaline batteries (+) positive side up.  
**NOTE:** Do not force the battery into the candlestick. Guide the battery past the metal contact at the top of the candlestick, and then it should drop with ease.  
**IMPORTANT BATTERY INFO:**  
Use only new, fully charged alkaline batteries. Do not mix new and old batteries. Lithium, rechargeable, and heavy duty batteries are not recommended because battery life will be significantly reduced.
3. Replace bulb.
  - Candle will turn on once the bulb is fully screwed in.
  - The 6-hour timer is now set and will repeat daily.
  - To reset the daily timer, unscrew the bulb and screw back in at desired start time.

## HEIGHT ADJUSTMENT:

Candle height has two positions (13" and 11")

- Candle arrives in 11" height
- To adjust to 13" taller position, remove the rubber ring located at the base of the candlestick. Slide the candlestick up and out of the base. Replace rubber ring on the candlestick. Push candlestick into top portion of the base until secure.

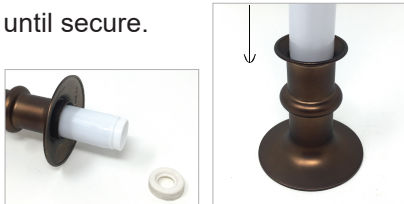

## 3 YEAR WARRANTY:

Our warranty covers any defect out of the box or any problems that may occur within three years of the purchase date. Warranty does not cover damages caused by improper use, storage, or handling.

We strive to make this process simple and pain-free!

For the most efficient service, please email us through our website: [www.612vermont.com](http://www.612vermont.com).

If preferred, call us toll-free: 1-877-750-0971

## REPLACEMENT PART(S) INFORMATION:

- Replace the bulb with model # VT-1935-R4-W
- Replace candlestick tube with model # VT-TUBE4AAW

## CARE:

- Remove alkaline batteries when not in use.  
*Batteries left in the candle when not in use can leak and cause corrosion.*
- Remove alkaline batteries when the candle dims.
- Dispose of used batteries responsibly.
- Store in a temperature controlled environment with normal humidity.

## TROUBLESHOOTING:

### 1. Candle Will Not Light

- Be sure to check the orientation of the alkaline batteries. This candle runs on 4x AA alkaline batteries. Batteries should all be (+) positive side up.

### 2. Timer Seems to be Incorrect (Not Working)

- This candle is equipped with an automatic 6-hour timer. It is set the moment the bulb is screwed down and light illuminates. Repeats each day for the same 6 hours ON and 18 hours OFF. To change the timer to another time during the day, you will need to unscrew the bulb, let the light turn off, and then re-screw down the bulb at the desired start time.

**NOTE:** The timer may reset because the candle is moved abruptly, dropped, or tilted. If you suspect this may have happened please reset the timer and set gently in position.

### 3. Light Appears Dim

- Make sure that alkaline batteries are new and fully charged. Do not mix old and new batteries. The candle should remain close to full brightness for about 30 days.
- One or more batteries facing the wrong direction (all should be (+) positive side up).

*Still having issues? Please reference the warranty information.*

Rollier Hardware, Inc  
DBA 612 Vermont®  
600 Washington Rd  
Pittsburgh, PA 15228  
[www.612vermont.com](http://www.612vermont.com)

Made in Taiwan

**WARNING!** This product is not a toy and not intended for use by children. Adult use only.